

**Phase 3- 7/29-8/4/21**  
Ground level Slabs & pits

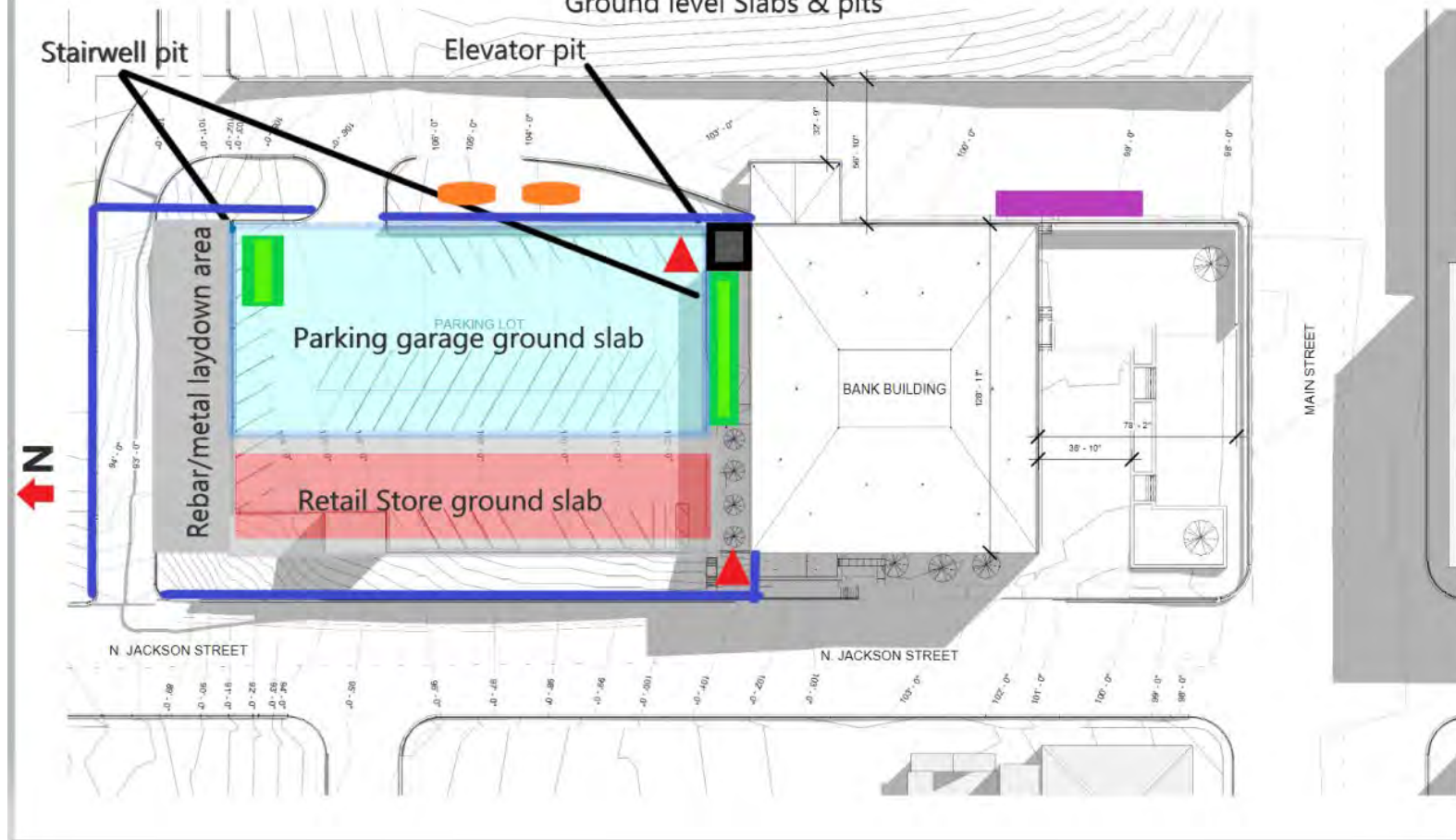

**Legend**

- Parking garage ground slab-
- Retail Store ground slab-
- Elevator pit-
- Stair well pits-
- Rebar/metal laydown-
- Port-a-toilet-
- Dumpster-
- Job Trailer-
- Construction Fence-

### Phase 3.5-7/25-8/4/21

Lull movement route

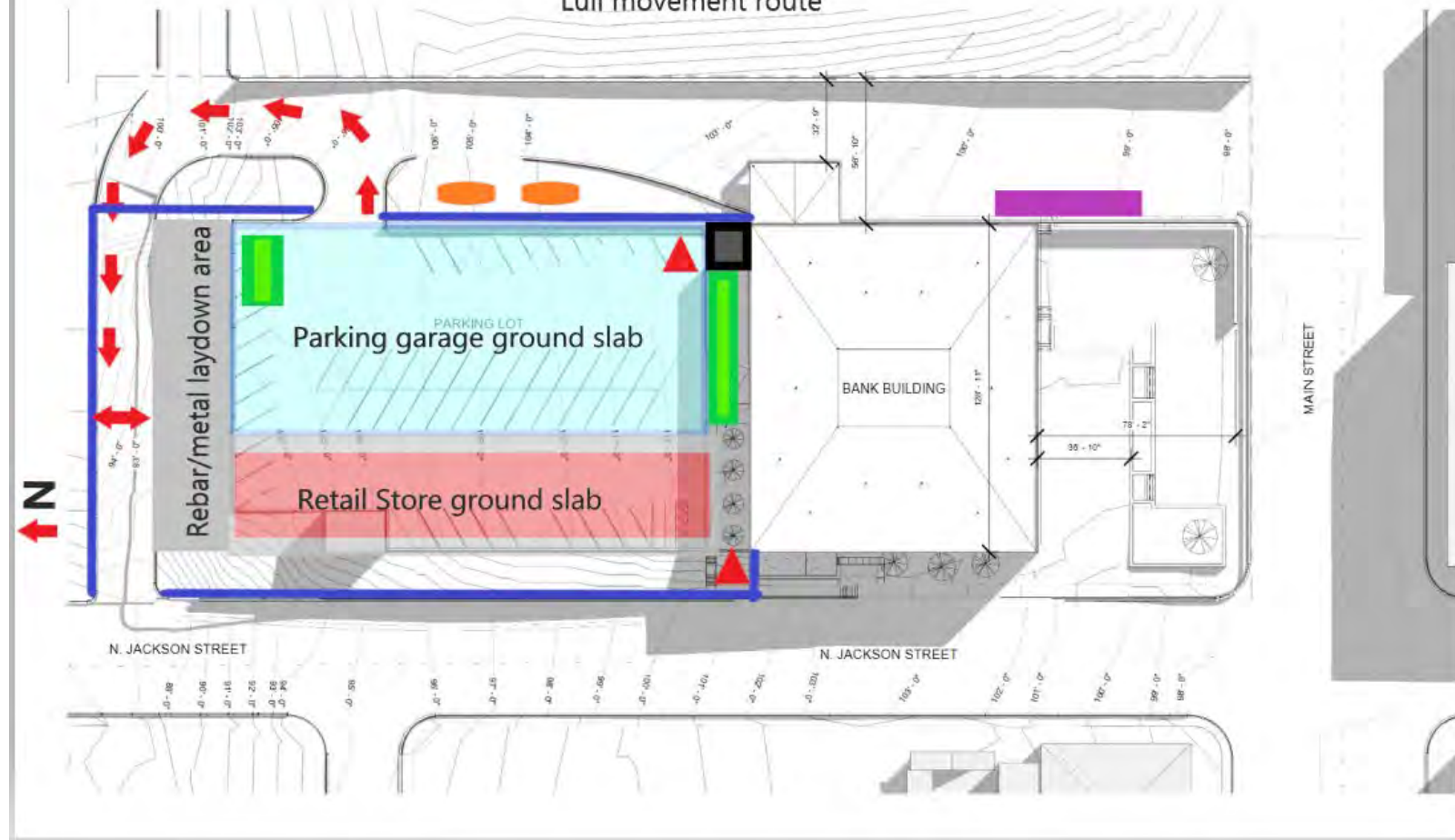

### Legend

- Parking garage ground slab- 
- Retail Store ground slab- 
- Elevator pit- 
- Stair well pits- 
- Rebar/metal laydown- 
- Lull movement route- 

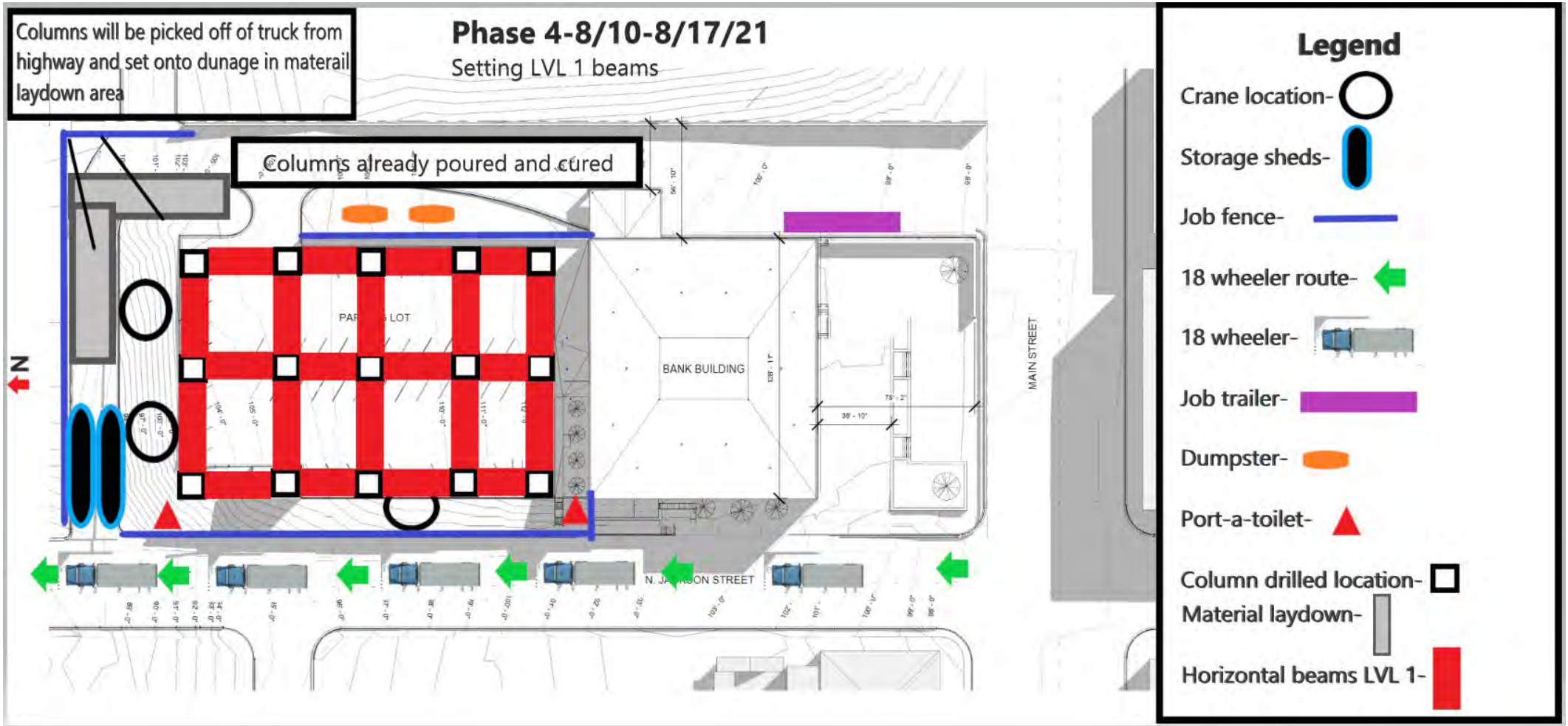

**Phase 5-8/18-8-25**  
Setting LVL 2 beams

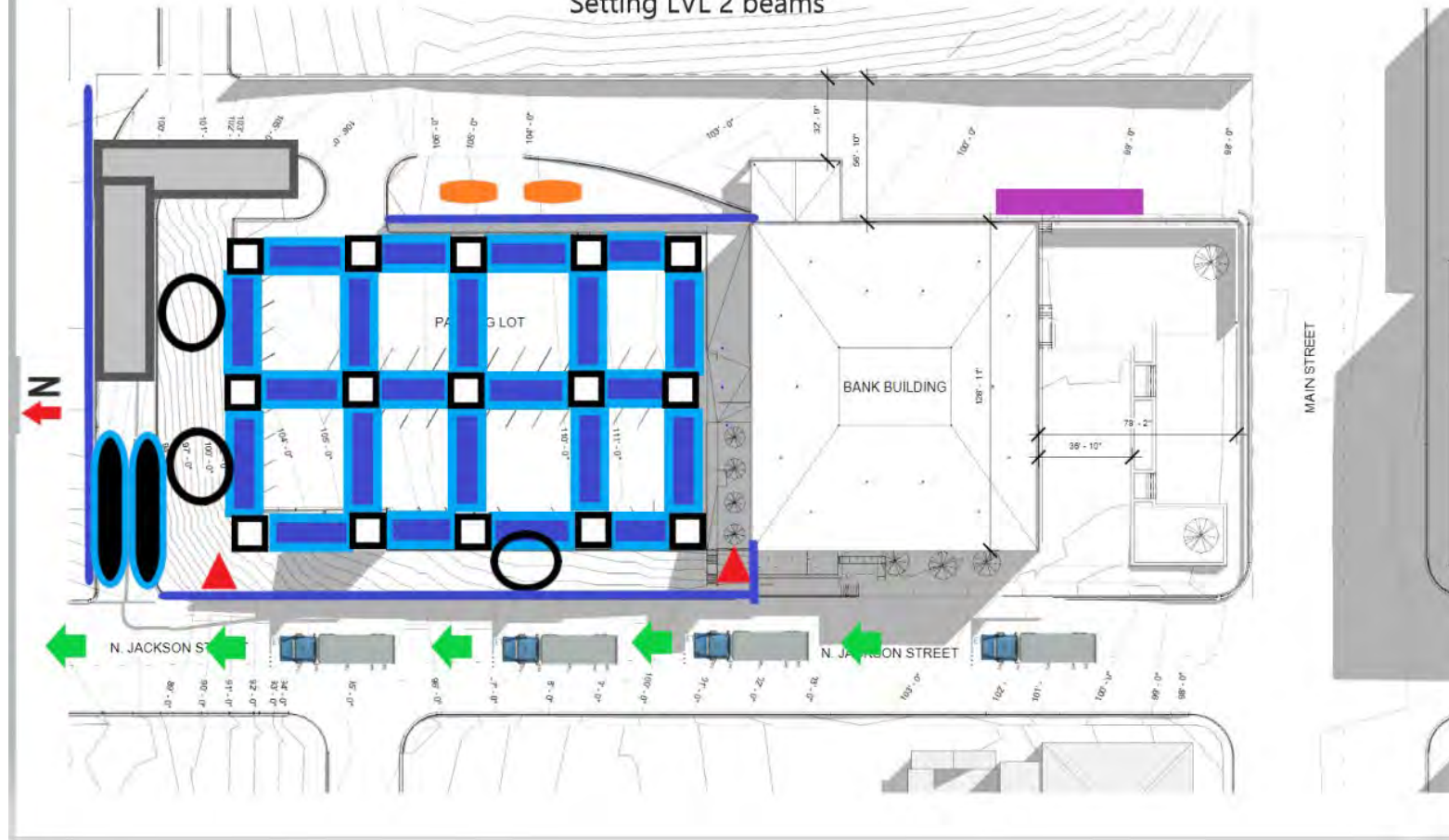

**Legend**

- Crane location- ○
- Storage sheds- 
- Job fence- 
- 18 wheeler route- 
- 18 wheeler- 
- Job trailer- 
- Dumpster- 
- Port-a-toilet- 
- Column drilled location- 
- Material laydown- 
- Horizontal beams LVL 2- 

### Phase 6-8/26-9/2/21

Set LVL 3 beams

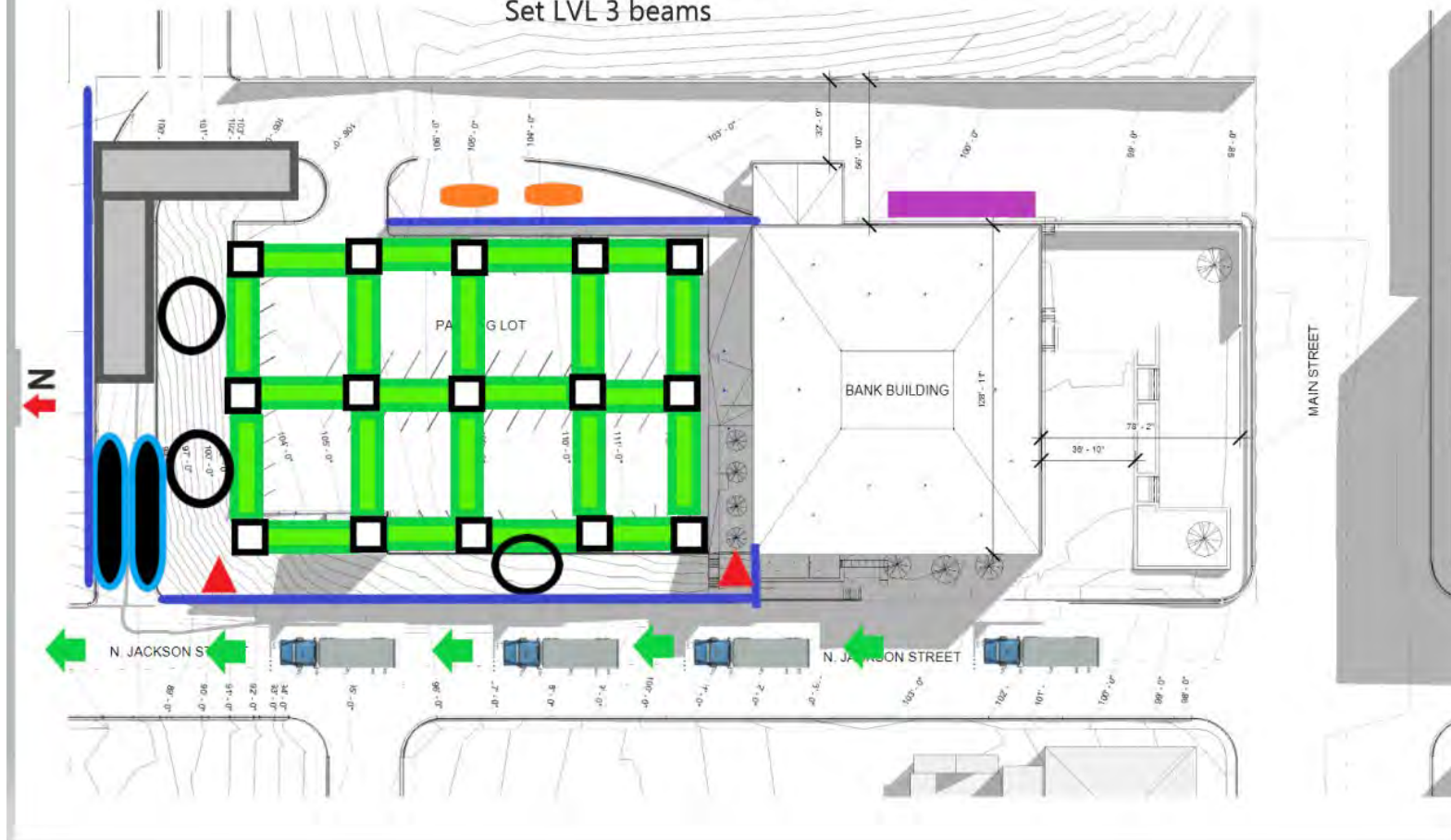

### Legend

Crane location- ○

Storage sheds- [blue oval]

Job fence- [blue line]

18 wheeler route- [green arrow]

18 wheeler- [truck icon]

Job trailer- [purple rectangle]

Dumpster- [orange oval]

Port-a-toilet- [red triangle]

Column drilled location- [square]

Material laydown- [grey rectangle]

Horizontal beams LVL 3- [green rectangle]

**Phase 7-9/3-11/3/21**  
Setting double tee beams

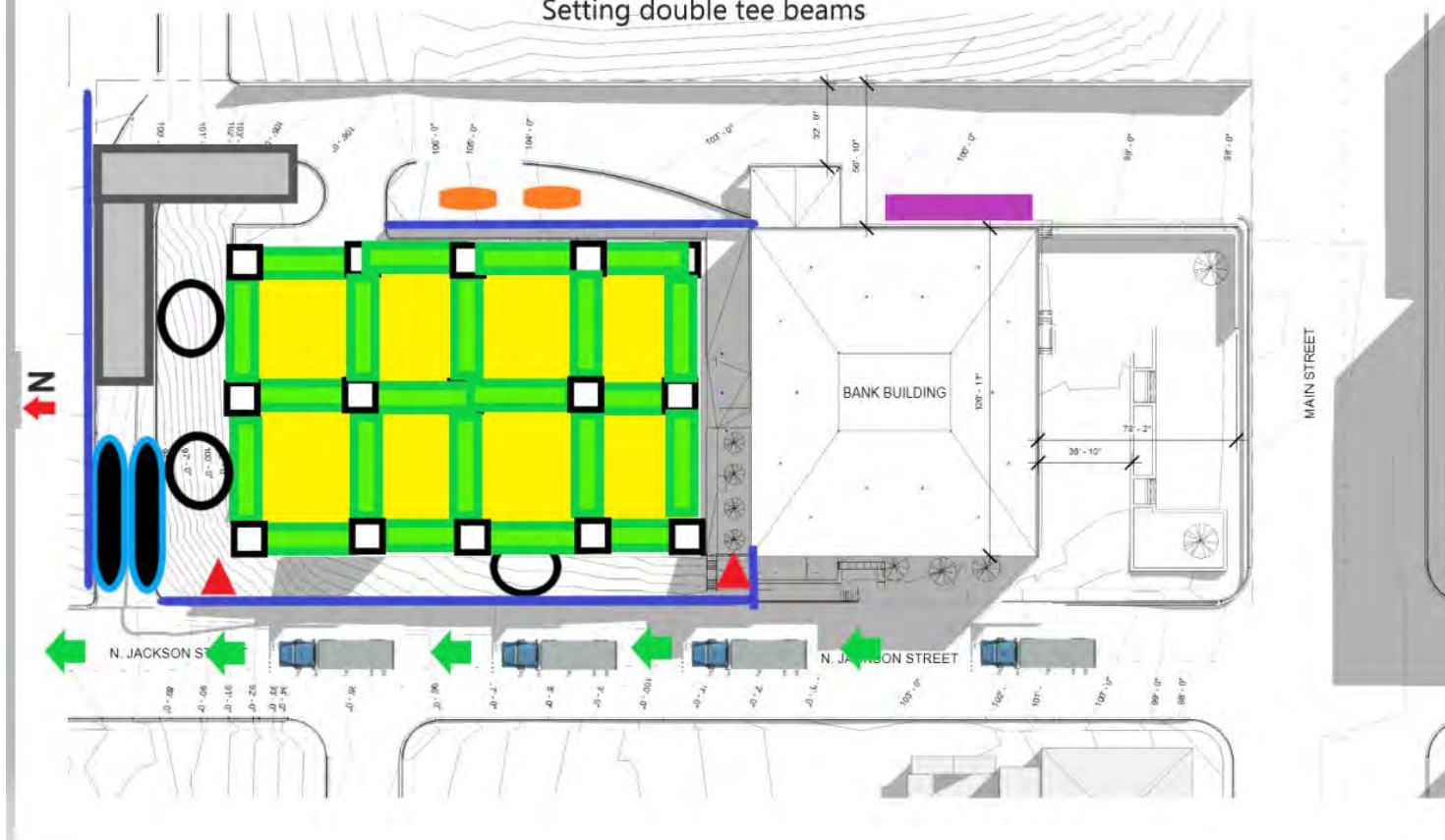

**Legend**

- Crane location- ○
- Storage sheds- [Blue oval]
- Job fence- [Blue line]
- 18 wheeler route- [Green arrow]
- 18 wheeler- [Truck icon]
- Job trailer- [Purple rectangle]
- Dumpster- [Orange oval]
- Port-a-toilet- [Red triangle]
- Column drilled location- [Black square]
- Material laydown- [Grey rectangle]
- Horizontal beams LVL 3- [Green rectangle]
- Double tee beams- [Yellow rectangle]





### Trucking Route Plan

Best Possible Route 

Construction Site 

Flagger/Lane Closure 

Studies show the effective single lane closure for fall/Spring school will occur -  
Monday-Friday - 06:00-07:00 / 16:00-17:00

Unloading  
Zone

Mississippi  
State

Tarkville

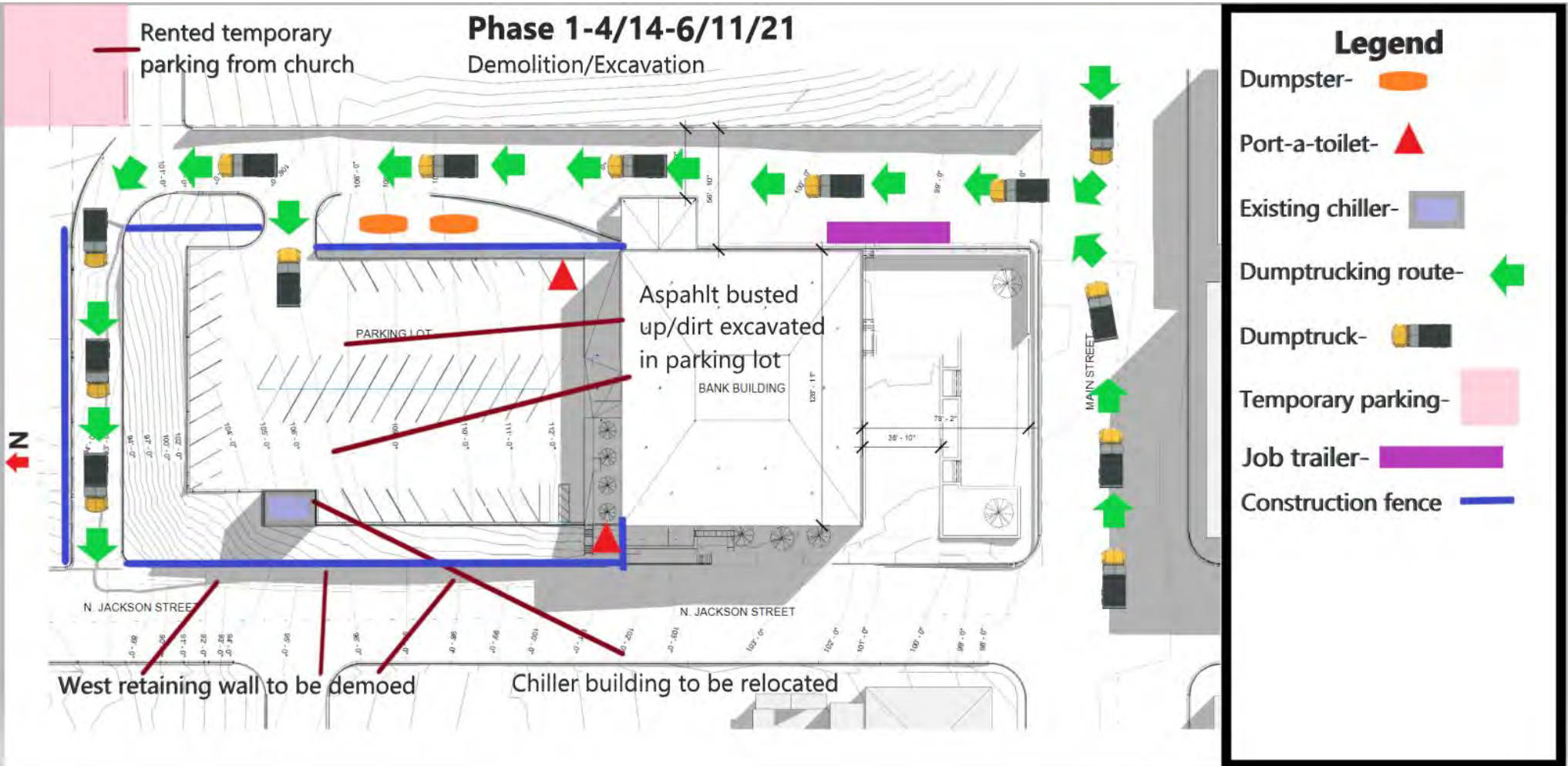

### Phase 2- 6/11-8/4/21





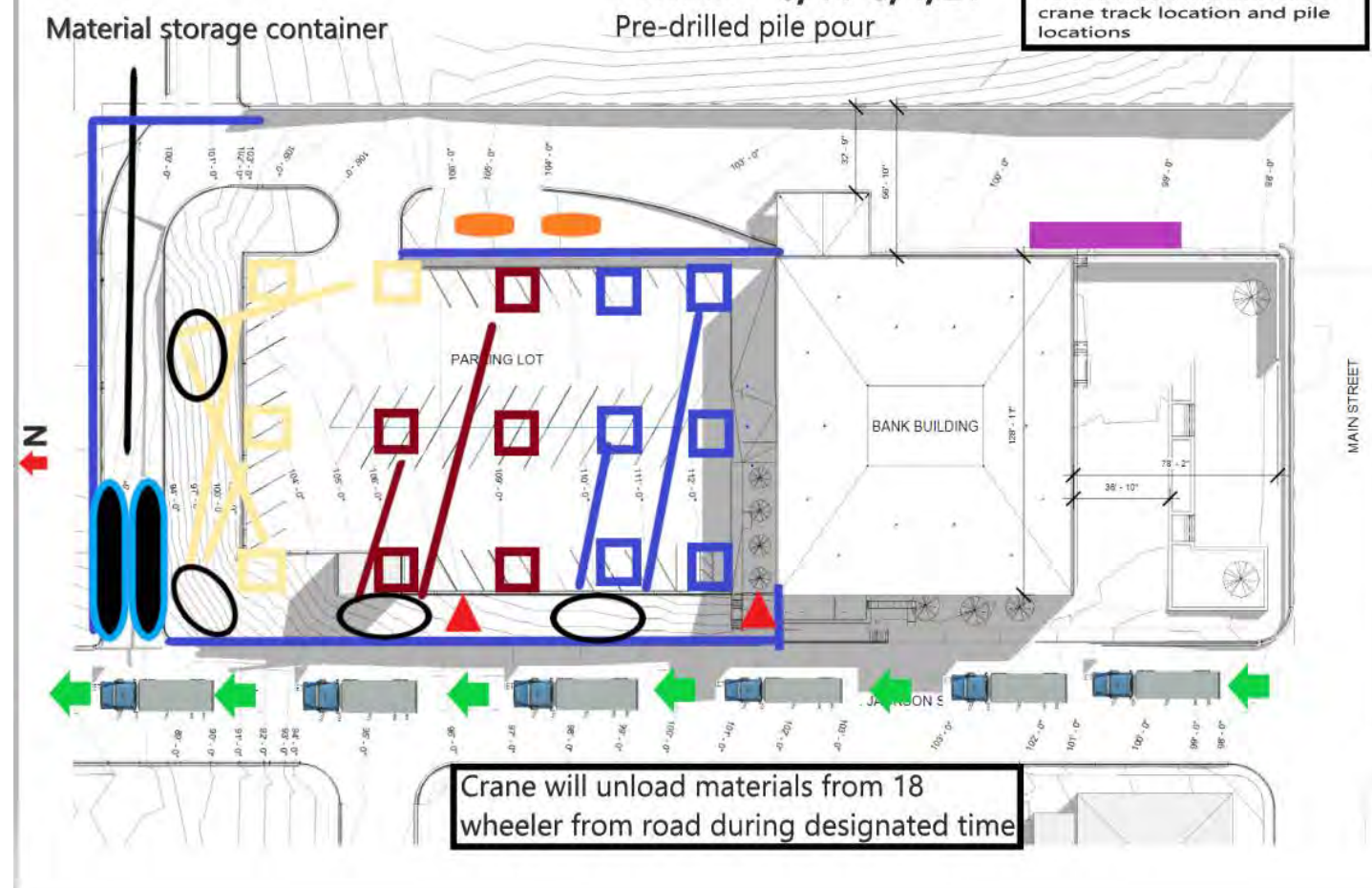





Pre-drilled pile pour

Crane will drill holes for piles in color coordination with the crane track location and pile locations



Crane will unload materials from 18 wheeler from road during designated time

### Legend

- Crane location- ○
- Storage sheds- 
- Job fence- 
- 18 wheeler route- 
- 18 wheeler- 
- Job trailer- 
- Dumpster- 
- Port-a-toilet- 
- Column drilled location-   

**Phase 3- 7/29-8/4/21**  
Ground level Slabs & pits

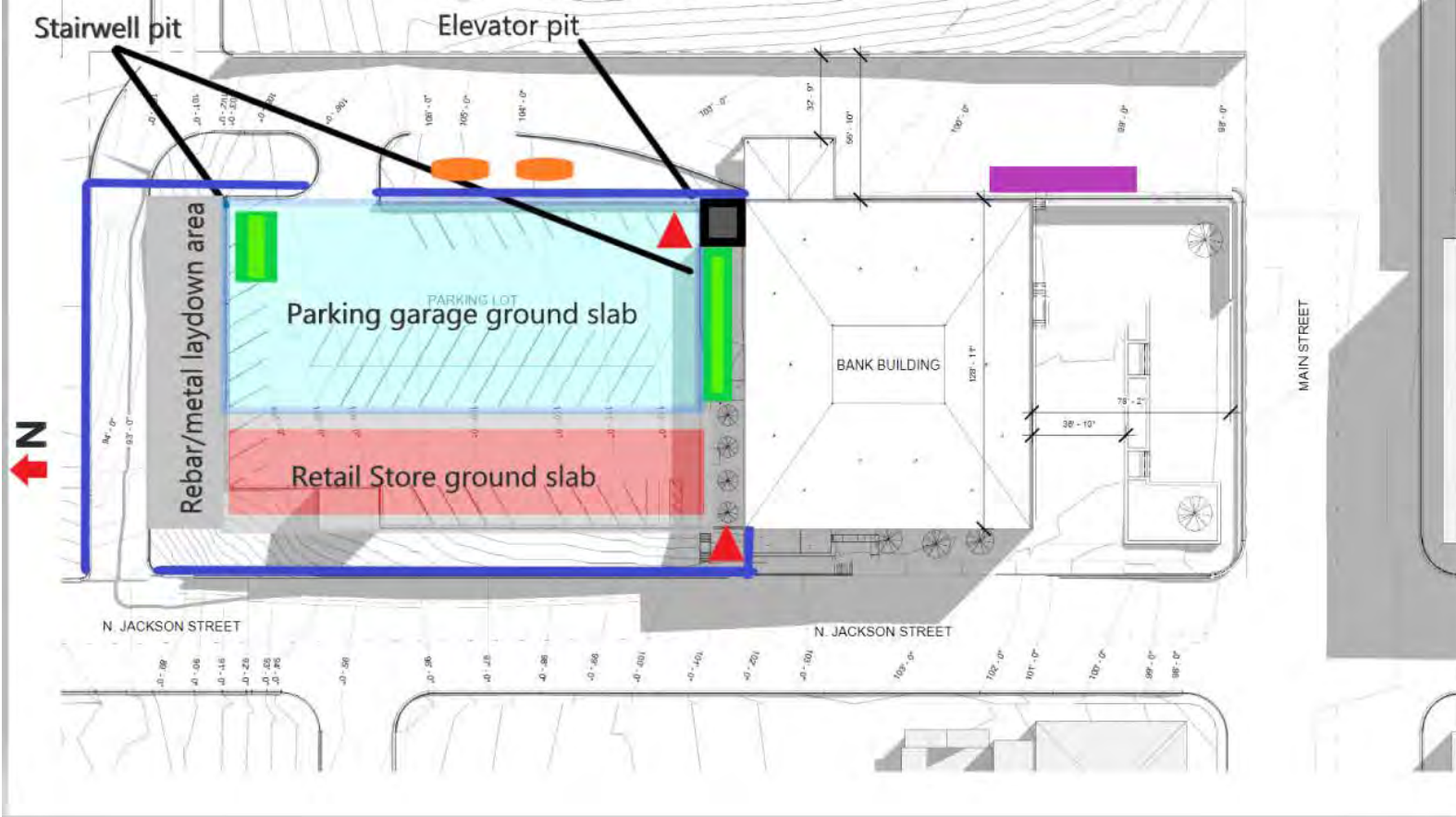

**Legend**

- Parking garage ground slab-
- Retail Store ground slab-
- Elevator pit-
- Stair well pits-
- Rebar/metal laydown-
- Port-a-toilet-
- Dumpster-
- Job Trailer-
- Construction Fence-

### Phase 3.5-7/25-8/4/21

Lull movement route

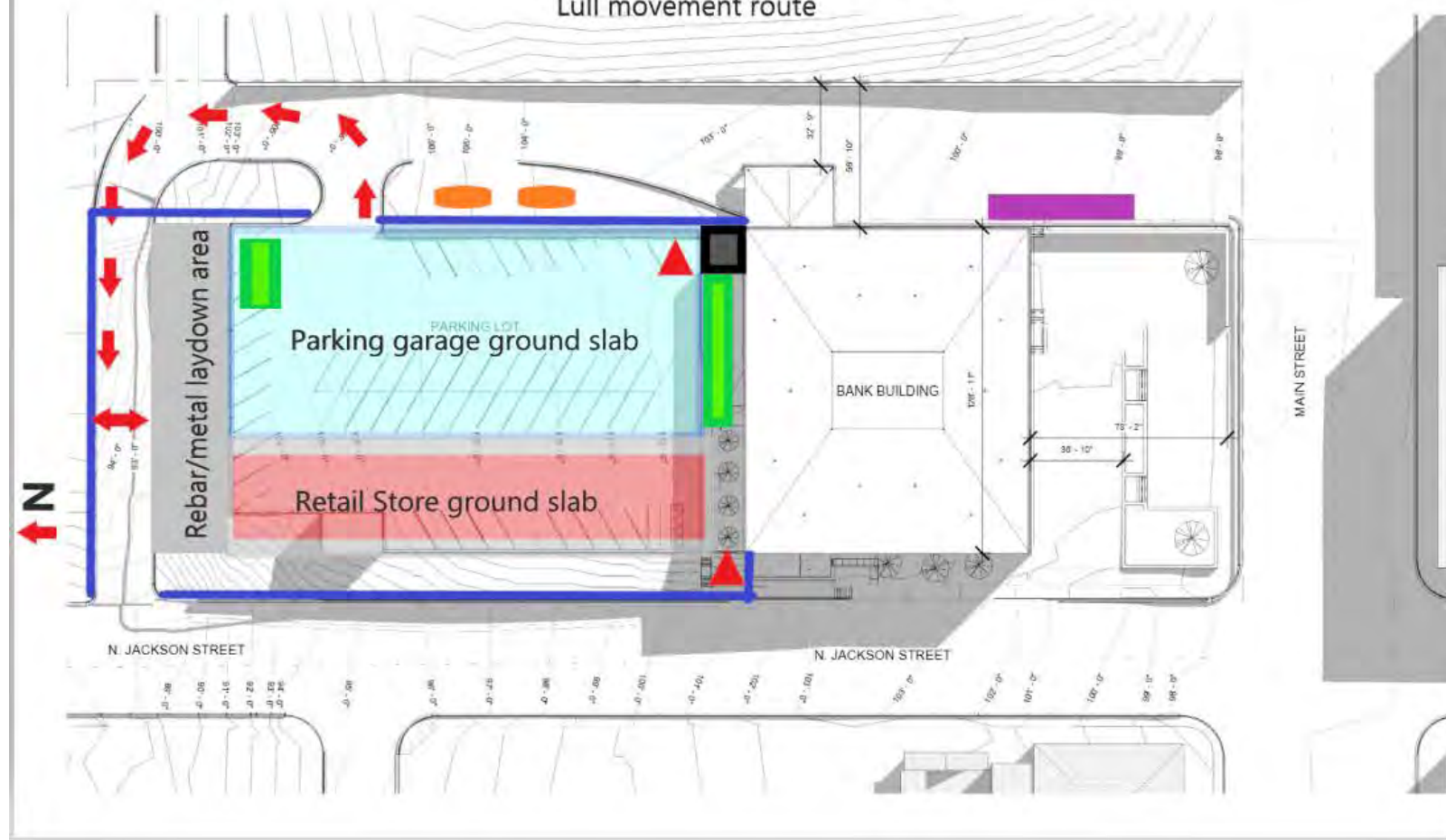

### Legend

- Parking garage ground slab- 
- Retail Store ground slab- 
- Elevator pit- 
- Stair well pits- 
- Rebar/metal laydown- 
- Lull movement route- 

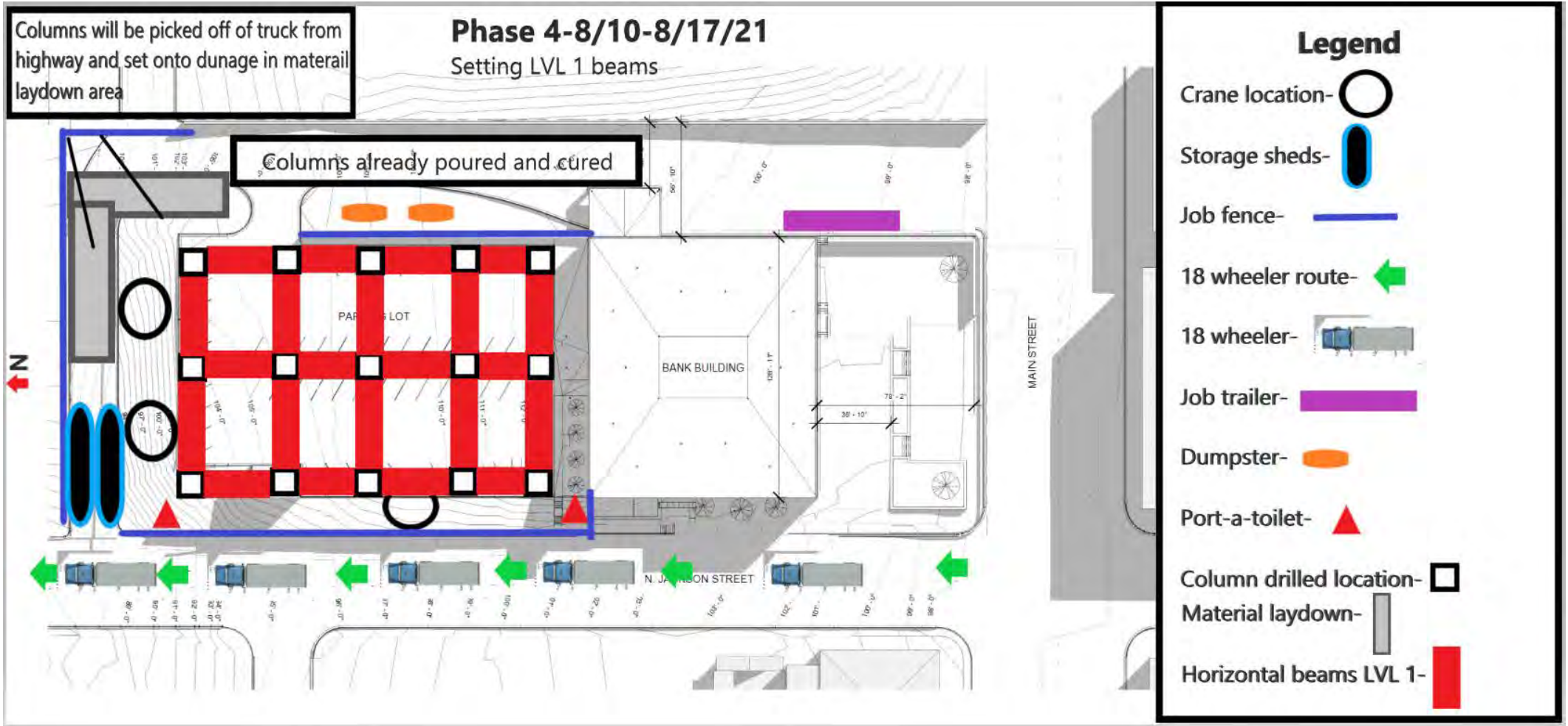

**Phase 5-8/18-8-25**  
Setting LVL 2 beams

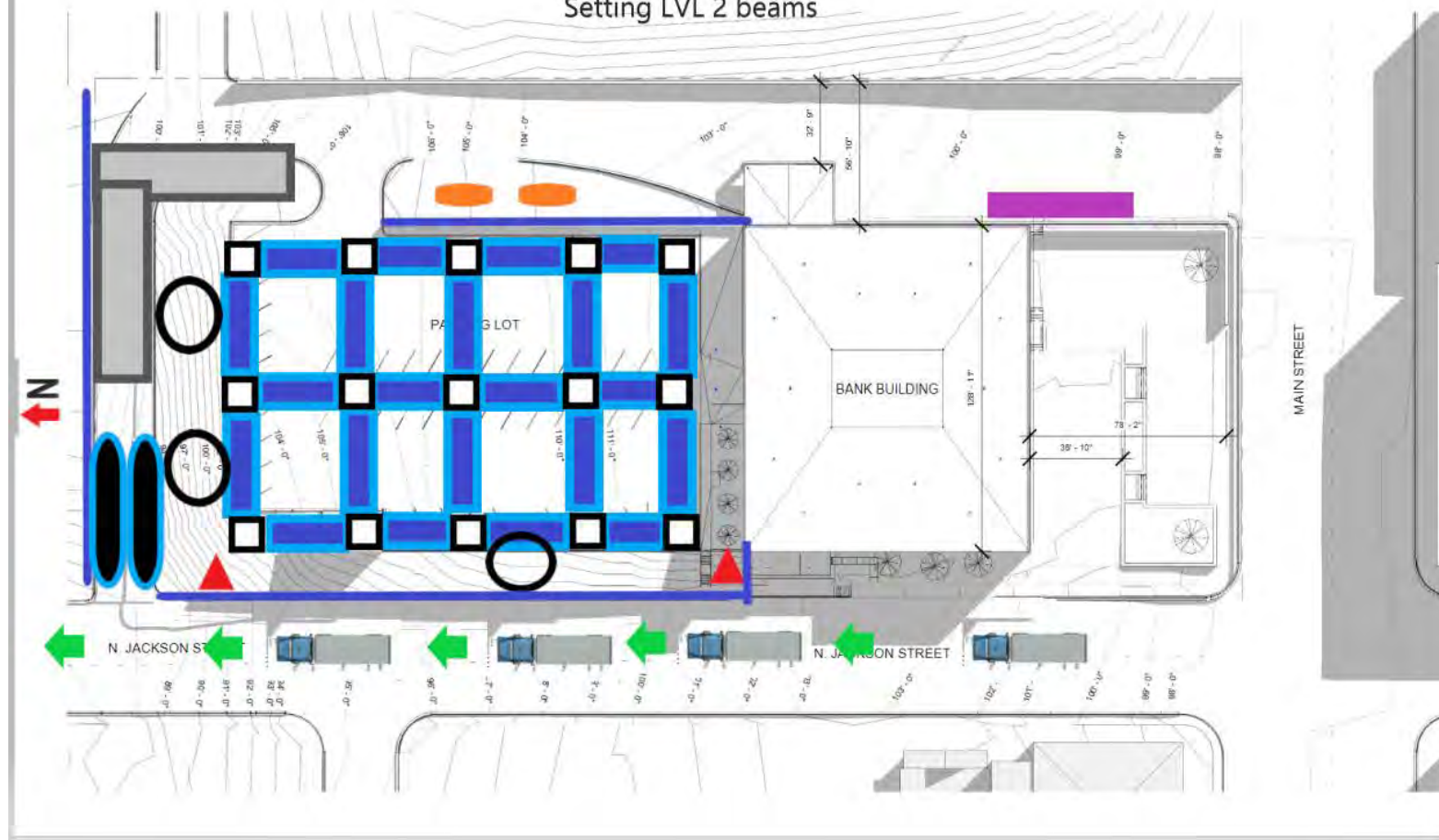

**Legend**

- Crane location- ○
- Storage sheds- 
- Job fence- 
- 18 wheeler route- 
- 18 wheeler- 
- Job trailer- 
- Dumpster- 
- Port-a-toilet- 
- Column drilled location- 
- Material laydown- 
- Horizontal beams LVL 2- 

### Phase 6-8/26-9/2/21

Set LVL 3 beams

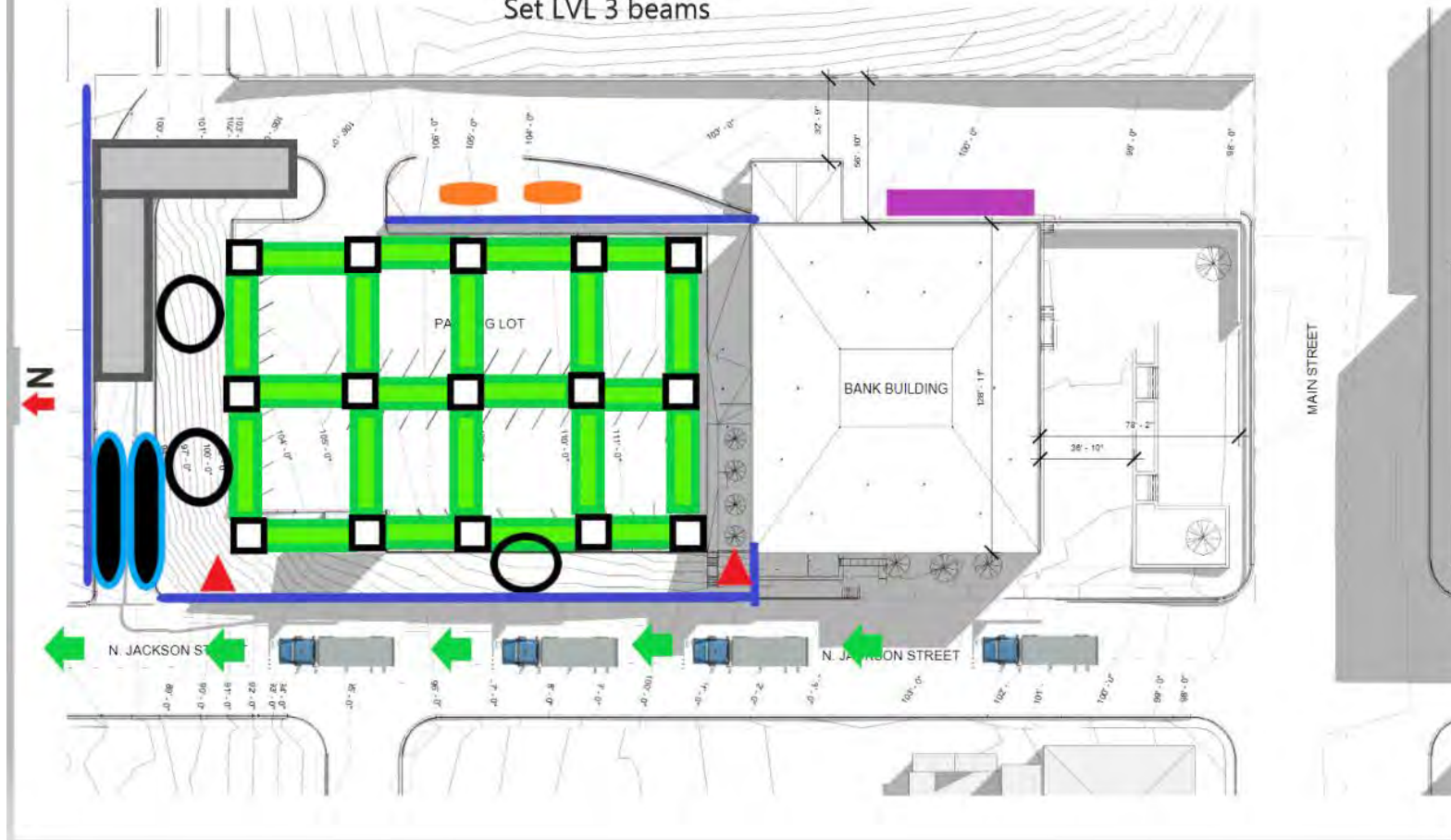

### Legend

Crane location- ○

Storage sheds- ▭

Job fence- —

18 wheeler route- →

18 wheeler- 🚛

Job trailer- ▭

Dumpster- ▭

Port-a-toilet- ▲

Column drilled location- □

Material laydown- ▭

Horizontal beams LVL 3- ▭



**Phase 7-9/3-11/3/21**  
Setting double tee beams



- Legend**
- Crane location- ○
  - Storage sheds- ▭
  - Job fence- —
  - 18 wheeler route- →
  - 18 wheeler- 🚛
  - Job trailer- ▭
  - Dumpster- ○
  - Port-a-toilet- ▲
  - Column drilled location- □
  - Material laydown- ▭
  - Horizontal beams LVL 3- ▭
  - Double tee beams- ▭

